



beyerdynamic

**UNITE**  
**USE CASES**

MAY 2019

# CONTENT

## See how Unite works in the following applications:

Page 3:	Guided tour	Page 13:	Interpretation – multi language transmission
Page 4:	Guided tour with talkback	Page 14:	Interpretation - broadcast of 4 languages
Page 5:	Guided tour with two guides	Page 15:	Assistive listening (without PA)
Page 6:	Guided tour with whispered interpretation (1)	Page 16:	Assistive listening
Page 7:	Guided tour with whispered interpretation (2)	Page 17:	Silent PA
Page 8:	Guided tour with two interpreters	Page 18:	Silent PA with access point
Page 9:	External audio input	Page 19:	Wireless intercom
Page 10:	Wireless microphone, PA, assistive Listening	Page 20:	Blind coverage
Page 11:	Multi room – wireless microphone, assistive listening	Page 21:	Legend
Page 12:	Multi room – assistive listening with 3 <sup>rd</sup> party mic		

# UNITE

## GUIDED TOUR

### Guide

Master



or



Unite TH

Unite TP+ TG H56 (TG)

### Visitors

Receivers

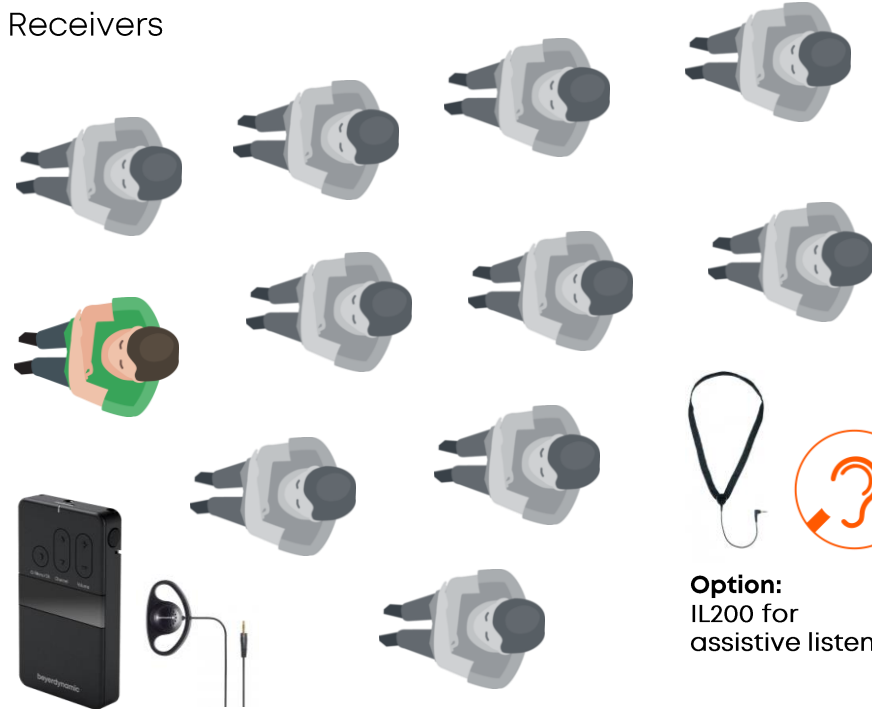

Unite RP + DT1



**Option:**  
IL200 for  
assistive listening



Up to 32 guided groups parallel

**beyerdynamic**

**DECT Connections**



Broadcast

# UNITE

## GUIDED TOUR WITH TALKBACK

### Guide

Master

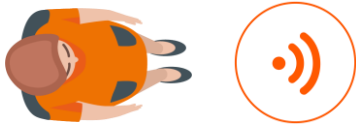

Unite TP + HSP321

### Visitors

Receiver with Talkback

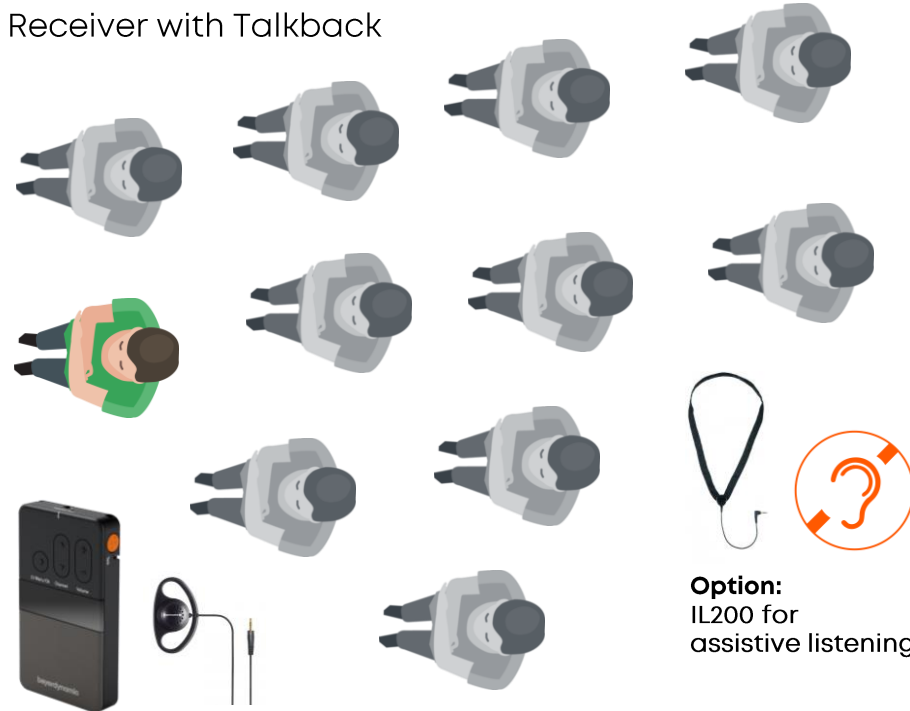

Unite RP-T + DT1

Option:  
IL200 for  
assistive listening





Talkback can be routed by the Master device to:

1. ALL = the whole group
2. Master device only
3. Master and all Sub-Master devices

beyerdynamic

### DECT Connections

-  Broadcast
-  Full-Duplex

# UNITE

## GUIDED TOUR WITH TWO GUIDES

### Guide

Master



Unite TP + HSP321

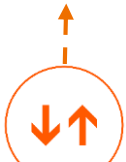

### Guide

Sub-Master



Unite TP + HSP321

### Visitors

Receiver

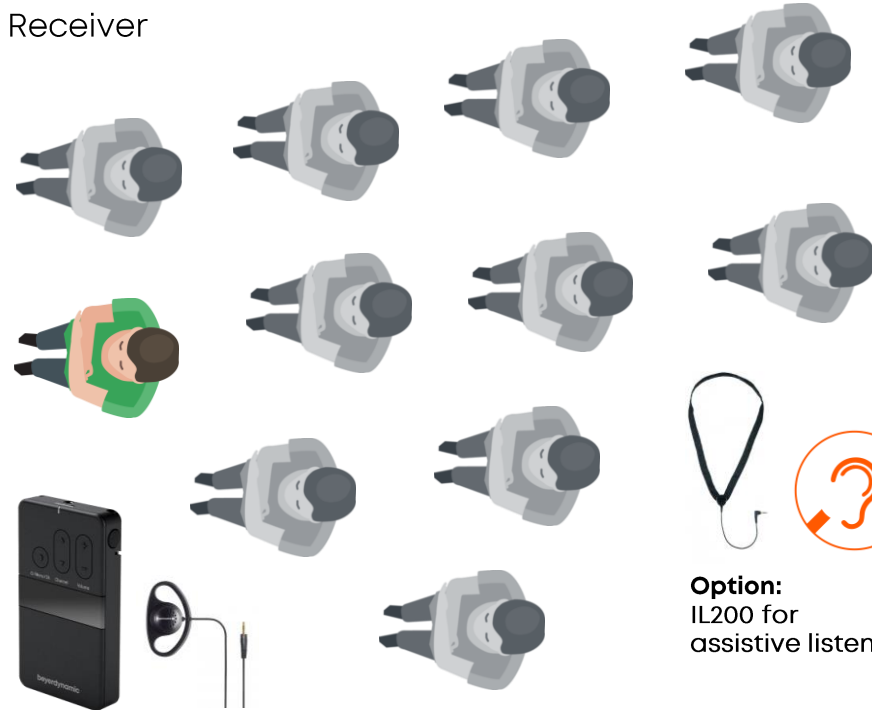

Unite RP + DT1



Option:  
IL200 for  
assistive listening

**Sub-Master signal can be routed by the Master device to:**

1. ALL = the whole group
2. Master device only
3. Master and all Sub-Master devices

**beyerdynamic**

**DECT Connections**

-  Broadcast
-  Full-Duplex

# UNITE

## GUIDED TOUR WITH WHISPERED INTERPRETATION (1)

### Guide

Master 1



 **Unite TP + TG H56 (TG)**



### Visitors

Receiver

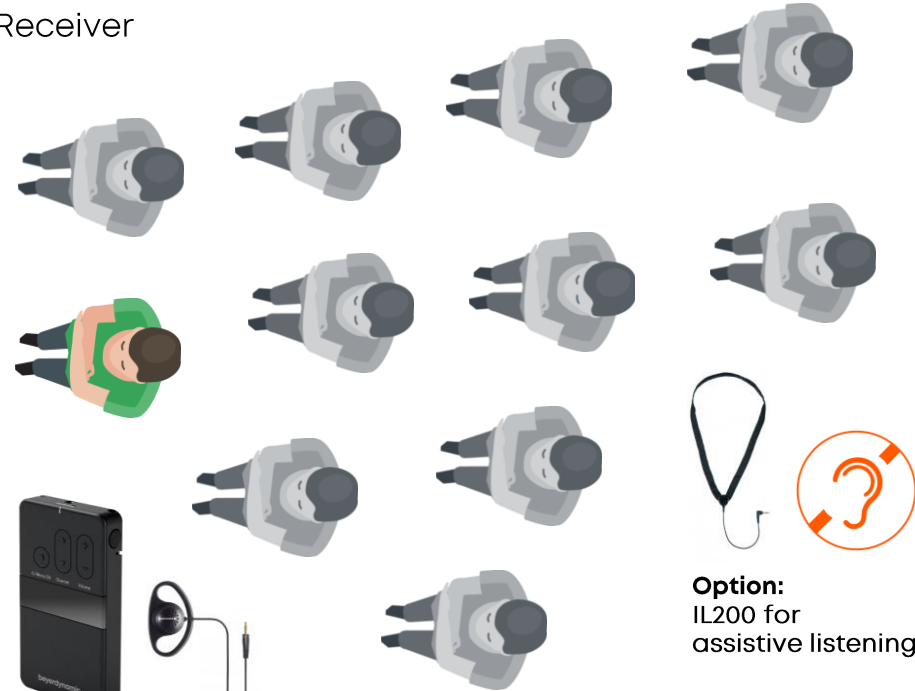

**Option:**  
IL200 for  
assistive listening

### Interpreter

Receiver + Master 2



 **Unite RP + DT2**  **Unite TH**



Select individually:

Language 1



Language 2



**Unite RP + DT1**

**beyerdynamic**

**DECT Connections**



# UNITE

## GUIDED TOUR WITH WHISPERED INTERPRETATION (2)

**Guide**  
Sub-Master



 **Unite TH**



**Interpreter**  
Master



 >  **Unite TP + HSP321**

**Visitors**  
Receiver

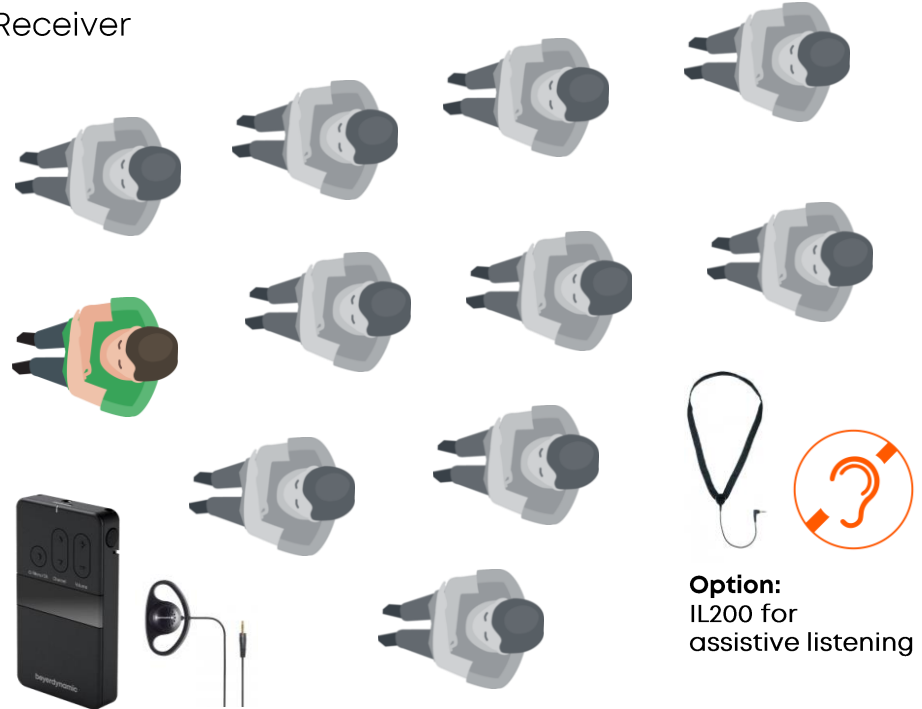

**Option:**  
IL200 for  
assistive listening

 **Unite RP + DT1**

### Setting on Master:

Menu: Talkback/Audio Routing/Sub-Masters/  
shall be set to „Master“ or „Master + Sub-Masters“  
This setting determines who can hear the sub-  
master audio signals.

**beyerdynamic**

### DECT Connections

-  Broadcast
-  Full-Duplex

# UNITE

## GUIDED TOUR WITH TWO INTERPRETERS

**Original Language**  
talkback activated

**Guide 1**  
Master



Unite TP + HSP321  
🇩🇪 > 🇬🇧



**Visitors**  
Receiver

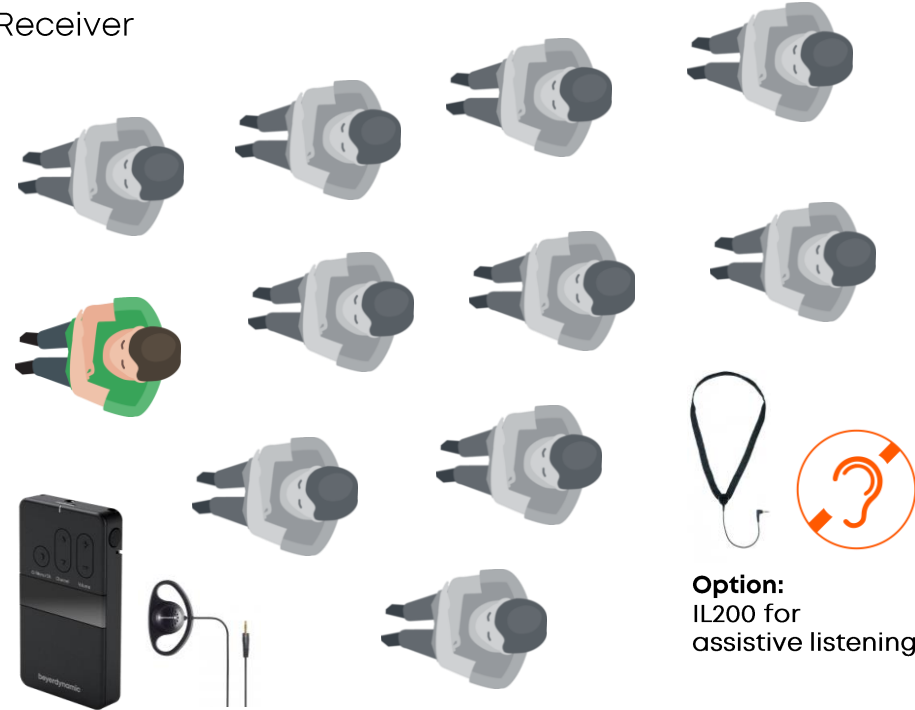

**Option:**  
IL200 for  
assistive listening

**Guide 2**  
Sub-Master



🇩🇪 > 🇬🇧 Unite TP + HSP321

🇬🇧 Unite RP + DT1

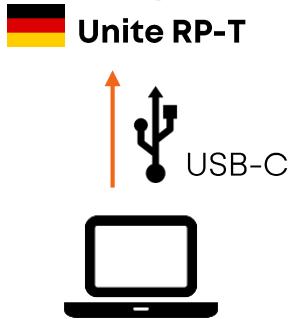

🇩🇪 Unite RP-T

USB-C

### Setting on Master:

Menu: Talkback/Audio Routing/RP Talkback/  
shall be set to „Master + Sub-Masters“  
This setting determines who can hear the talkback  
audio signals from RP-T devices.

**beyerdynamic**

→ digital

### DECT Connections

-  Broadcast
-  Full-Duplex



# UNITE

## EXTERNAL AUDIO INPUT

### Unite TP interfaces

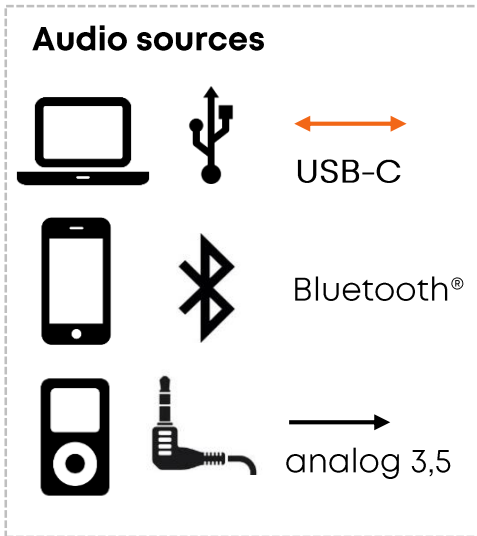

Unite TP

### Details on audio Sources:

Regardless of whether your Unite TP is configured as master or sub-master, you have the option of importing external audio signals into the group via USB-C, Bluetooth or analog.

Please note the following special aspects:

#### 1. USB-C

You can connect any computer to your Unite TP using a USB to USB C cable. Your computer will recognize the Unite TP as an audio interface for input and output. Not only can you play audio into the Unite TP, you can also output or record everything that has been routed to the TP in the group on a PC. By the way, ALL mobile Unite devices have this feature.

#### 2. Bluetooth®

Bluetooth® can be used in two different configurations. Either as a headset (talk and listen) or as a PC/Phone for inputting and outputting audio signals. Please note that you can use either Bluetooth or USB. Both are unfortunately not possible at the same time. Bluetooth® is only available on the Unite TP.

#### 3. Analog

The Unite TP has an analog AUX input via 3.5mm mini-jack. The recorded audio signal is summed to a mono signal.

#### Use the Ducker!

Ducking is a common expression in sound engineering for giving specific automatic prominence to an audio signal. This is achieved by decreasing other signals rather than increasing the user signal to be given prominence. This effect can guarantee speech intelligibility. Depending on the setting, the USB, Bluetooth or analog AUX signal is lowered or suppressed as soon as the microphone source of the Unite TP is discussed.

**beyerdynamic**

→ digital

→ analog

# UNITE

MOBILE EVENT - WIRELESS MICROPHONE, PA, ASSISTIVE LISTENING

## Speaker 2 Sub-Master



Unite TP + TG H56 (TG)



Unite RP



## Audience Receiver

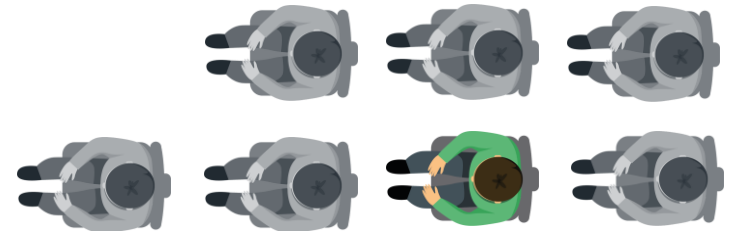

## Speaker 1 Master



Unite TP + TG H56 (TG)



Option:  
Unite TH  
Audience Microphone  
Sub-Master

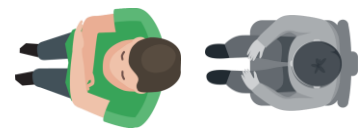

Unite RP + IL 200  
for hearing aids /  
cochlea implants

beyerdynamic

DECT Connections

-  Broadcast
-  Full-Duplex

→ analog

# UNITE

WIRELESS MICROPHONE, ASSISTIVE LISTENING – MULTI ROOM SOLUTION

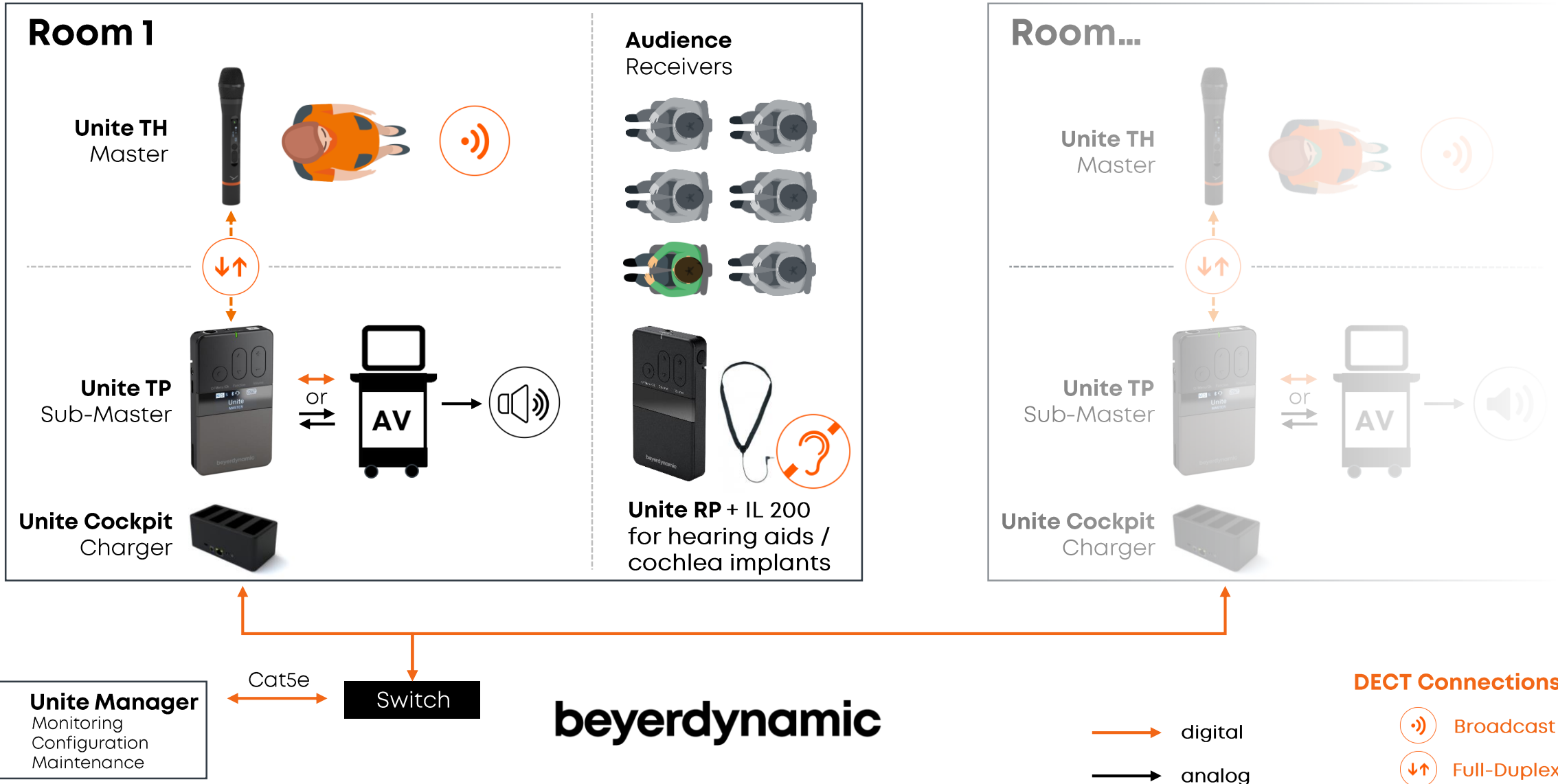

# UNITE

## ASSISTIVE LISTENING- MULTI ROOM SOLUTION 2

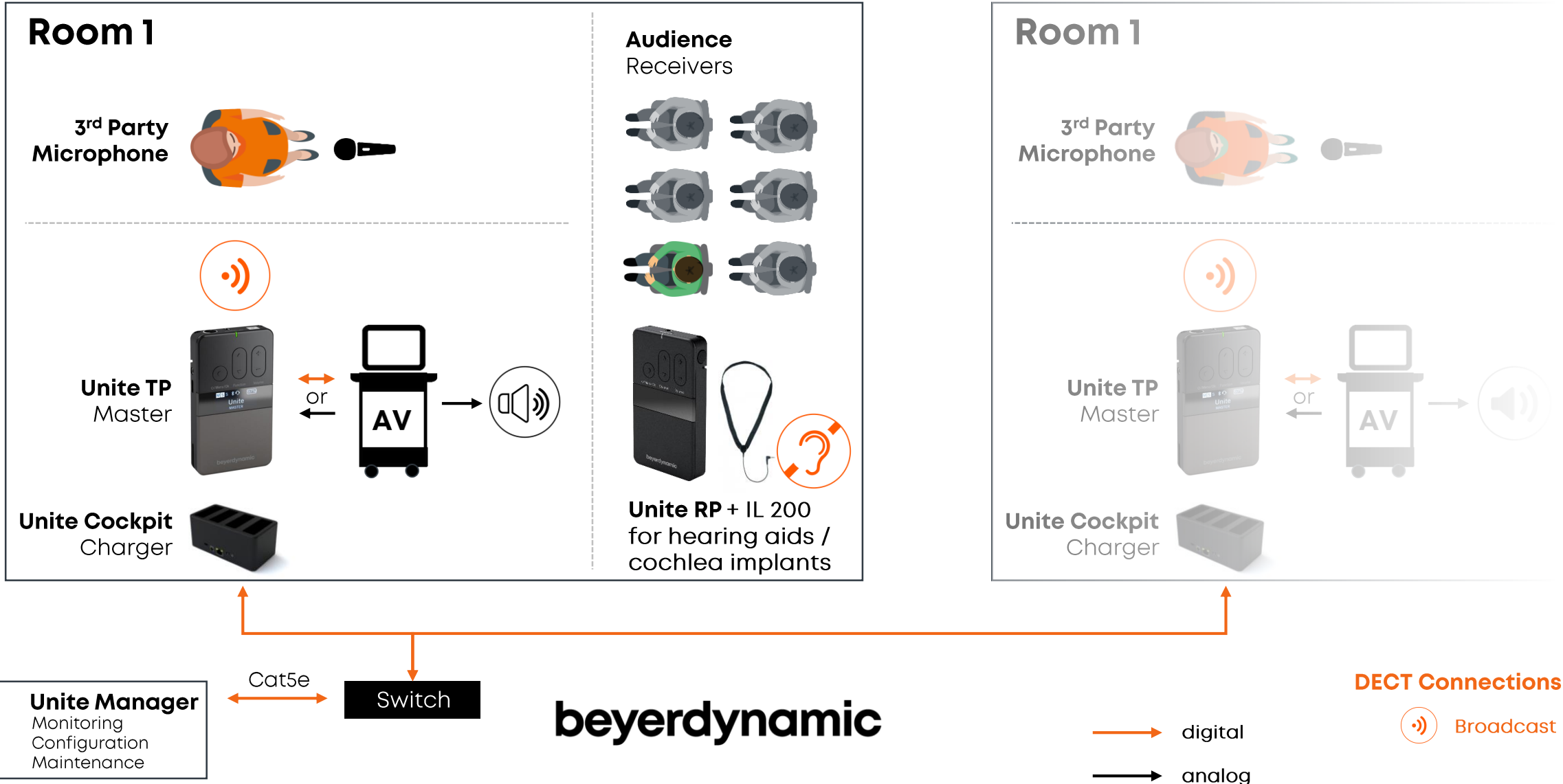

# UNITE

MULTI LANGUAGE TRANSMISSION (7+1 LANGUAGES)

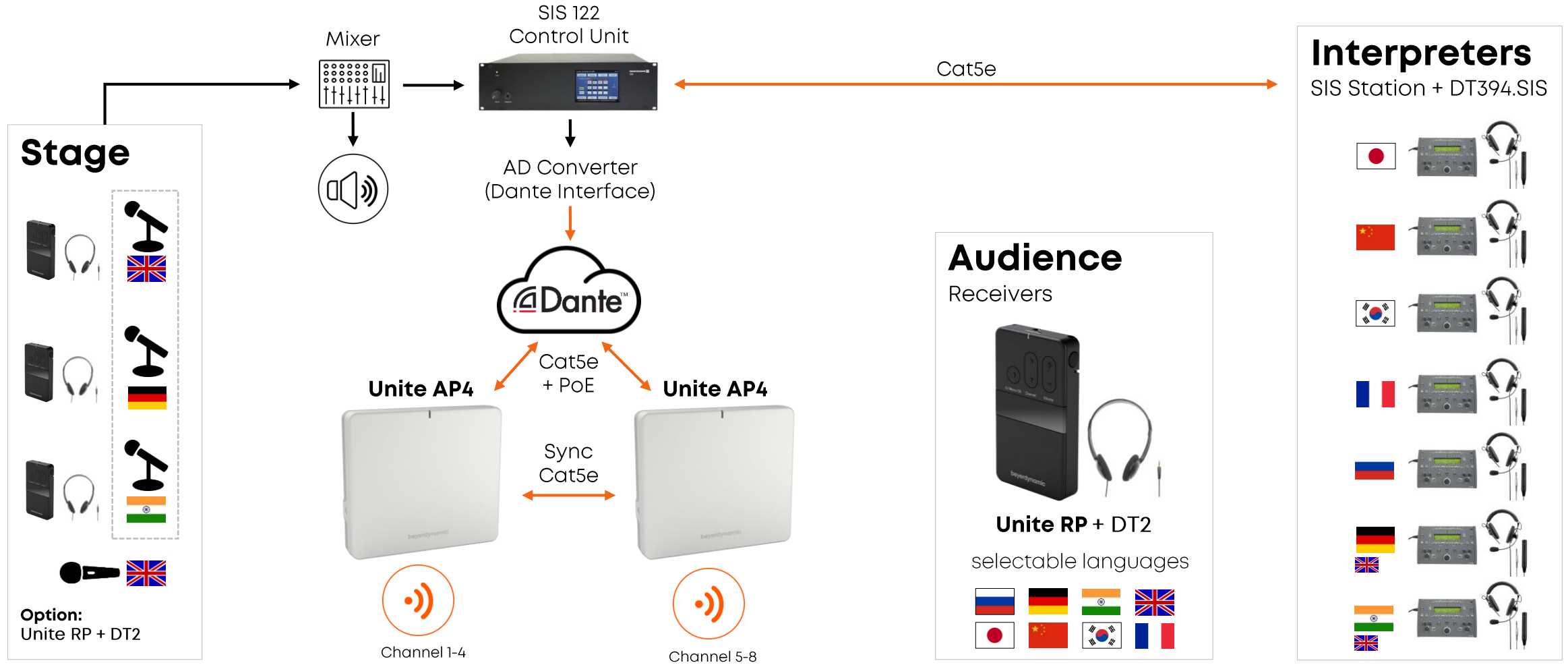

beyerdynamic

→ digital  
→ analog

DECT Connections

→ Broadcast

# UNITE

BROADCAST OF 4 LANGUAGES



beyerdynamic

→ digital  
→ analog

DECT Connections

Ⓢ Broadcast

# UNITE

SMALL EVENT WITH ASSISTIVE LISTENING (WITHOUT PA)

## Speaker

Master



Unite TP + TG H56 (TG)

or



Unite TH



## Audience

Receiver

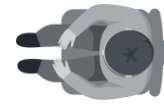
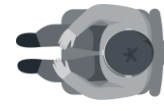
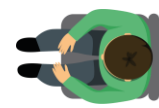

Unite RP + IL 200  
for hearing aids /  
cochlea implants

# UNITE

## ASSISTIVE LISTENING – INCLUSION FOR THE HARD OF HEARING



beyerdynamic

→ digital  
→ analog

→ Broadcast



# UNITE

SILENT PA – SELECT YOUR ONE OF 32

**Speech 1**  
Master 1



**Unite TP**  
+ TG-H56 (TG)

**Speech 2**  
Master 2



**Unite TH**

**Speech 3**  
Master 3



**Unite TH**



**Speech 32**  
Master 32



**Unite TH**

**Audience**  
(Receiver)



**Select:**  
Speech 1  
Speech 2  
Speech 3 ...  
Speech 32



**Unite RP + DT2**



**Option:**  
IL200 for  
assistive listening

**beyerdynamic**

**DECT Connections**



# UNITE

DIGITAL MULTICHANNEL TRANSMISSION - SILENT PA WITH ACCESS POINT



beyerdynamic



# UNITE

WIRELESS INTERCOM – COMMUNICATE OVER 300 METERS

## TRAINER/ COMMANDER

Master

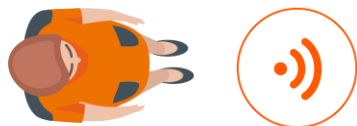

Unite TP + HSP321

## TEAM

Receivers with Talkback

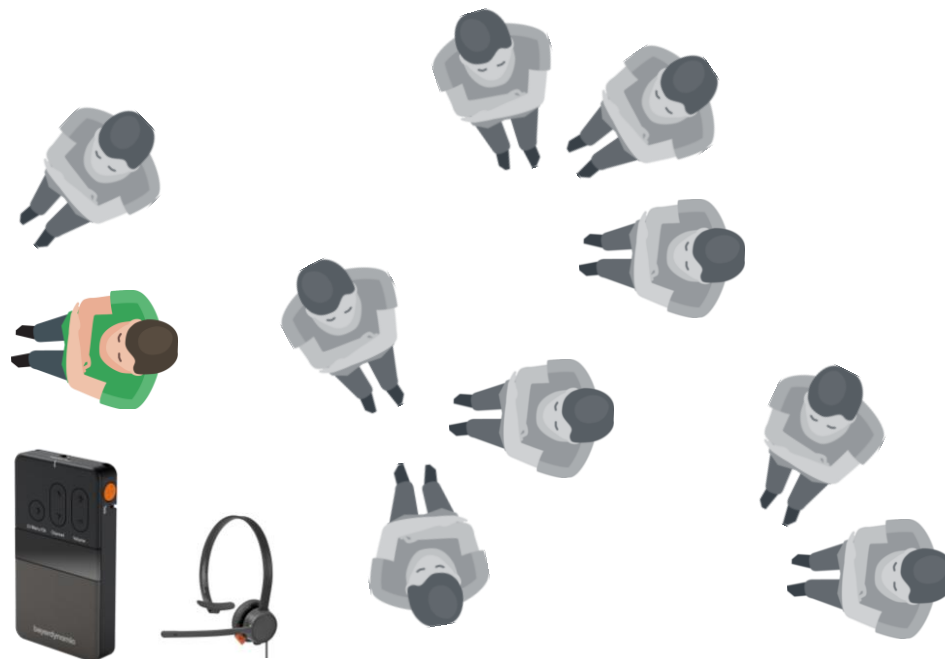

Unite RP-T + HSP321



Talkback can be routed by the Master device to:

1. ALL = the whole group
2. Master device only
3. Master and all Sub-Master devices

beyerdynamic

DECT Connections



# UNITE

BLIND COVERAGE – WITH TWO REPORTER AND MONITORING

## Audience

Receiver



Unite RP + DT2

Unite TP  
+ DT 287 Unite

## Reporter 1

Master



## Reporter 2

Sub-Master



**Sub-Master signal can be routed by the Master device to:**

1. ALL = the whole group
2. Master device only
3. Master and all Sub-Master devices

**beyerdynamic**

**DECT Connections**

-  Broadcast
-  Full-Duplex

# UNITE

## LEGEND

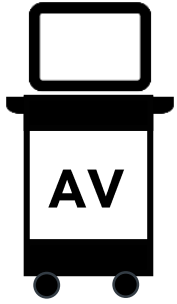

Media rack

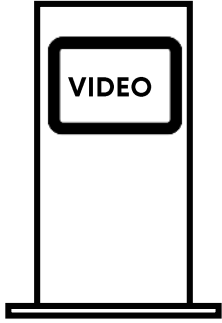

Screen



Laptop/PC



Unite Manager Software



Master/  
Sub-Master

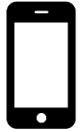

Smart device



Player



3rd party microphone



USB-C



Bluetooth®



Jack 3,5

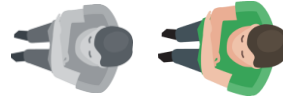

Visitor (active)



- DECT Connection: Broadcast**
- Uni-directional (one way)
  - One master device and unlimited receiver devices
  - One speaker, many listener
  - No backward channel



- DECT Connection: Full-Duplex**
- Bi-directional
  - Just two devices communicate (point-to-point)
  - Two devices can speak and listen simultaneously
  - Like a DECT phone: Base station and mobile device  
With Unite: Unite RP-T talkback and sub-master connections to master



Hint



Assistive Listening



digital



analog



beyerdynamic

**UNITE**  
**THE PEOPLE**

[WWW.BEYERDYNAMIC.COM/UNITE](http://WWW.BEYERDYNAMIC.COM/UNITE)

**your beyerdynamic**